

Model: NAD 30S/30/40		Date: 31-May-98	No: 3
Subject: Service Manual Corrections		Prepared by: Y. Furuya	
From: Technical Service Department.			
Classification:	<input type="checkbox"/> Troubleshooting	<input type="checkbox"/> Part information	<input type="checkbox"/> Action required
	<input type="checkbox"/> Mechanical	<input type="checkbox"/> Electrical	<input checked="" type="checkbox"/> Service manual revision
	<input type="checkbox"/> Paper path	<input type="checkbox"/> Transmit/receive	<input type="checkbox"/> Retrofit information
	<input type="checkbox"/> Other (      )		

This bulletin contains corrections for the Fax Option Type 450 service manual.

---

## Chapter 3

### ***Problem***

- 1) The installation procedure was not suitable for the Taiwan version
- 2) A bracket must be removed before installing the expansion box; this was not mentioned.
- 3) The procedure for attaching the PTT approval label was missing.

### ***Correction***

- 1) The installation procedure has been modified for all versions, including Taiwan.
- 2) Missing steps have been added. (Items 2 and 3 above; refer to pages 2 to 5.)

**NOTE:** To install the fax unit, the Expansion Box Type 450 is required in addition. The following procedure is written on the premise that the expansion box has not been installed.

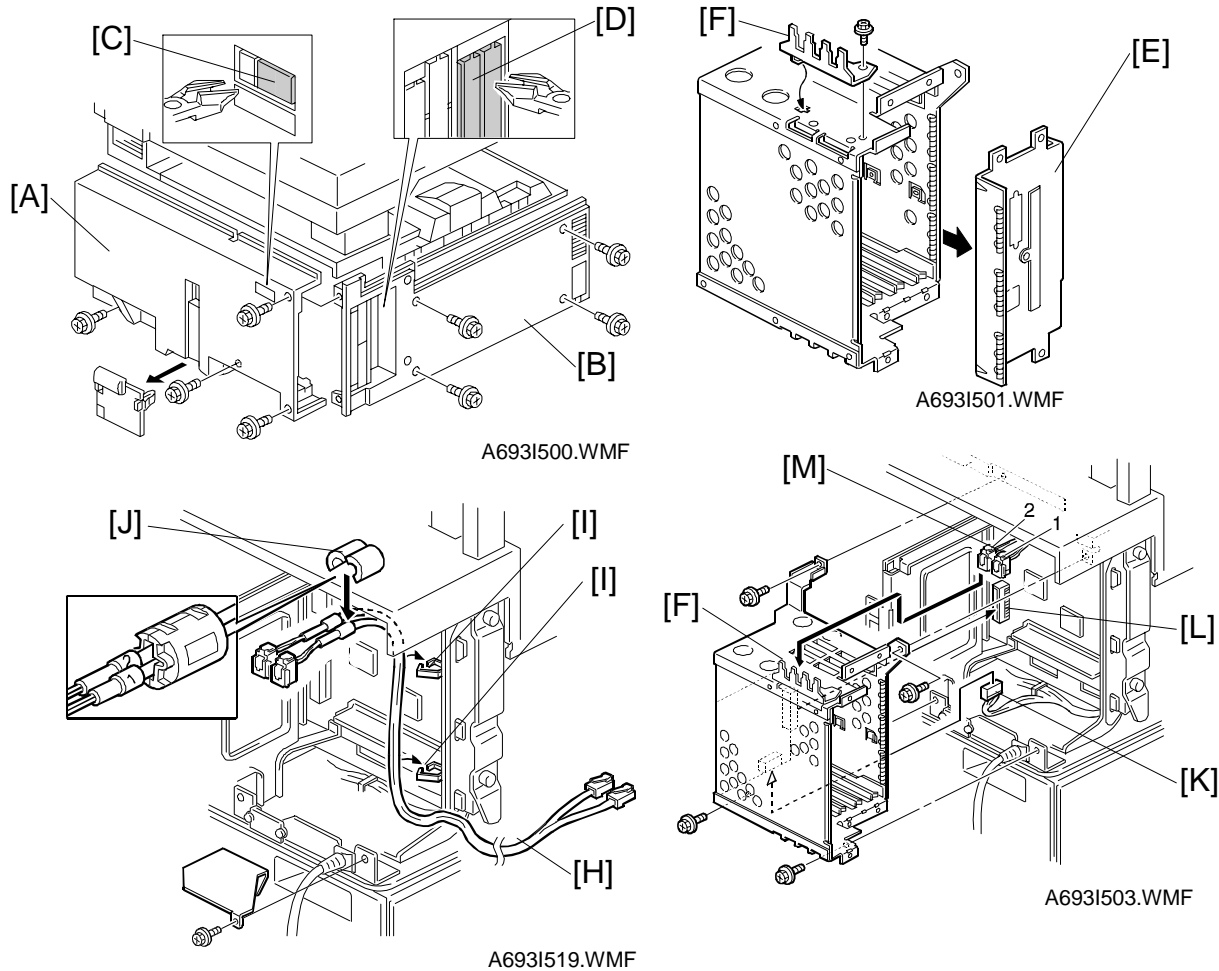

1. Remove the rear cover [A] (4 screws) and the left side cover [B] (4 screws), as shown.
2. Cut away the covers [C] and [D] (shaded parts), as shown.  
**NOTE:** If installing the fax hard disk option at the same time, refer to the hard disk installation procedure before going on to the next step.
3. Remove the cover [E] from the expansion box, then install the FCU cover bracket [F] (1 screw) as shown.  
**NOTE:** The bracket [F] is included in the fax unit.
4. Remove the bracket [G], and run the cable [H] through the clamps [I], then install a metal core [J] as shown.  
**NOTE:** The metal core [J] is not installed the model for Taiwan.
5. Connect the harness [K] to CN355 on the expansion box, then install the expansion box (4 screws) so that the CN350 fits in CN304 [L] on the BiCU.  
**NOTE:** Use a magnetic screwdriver so as not to drop any screws inside the machine.
6. Attach the modular jacks [M] to the bracket [F] as indicated on the bracket.

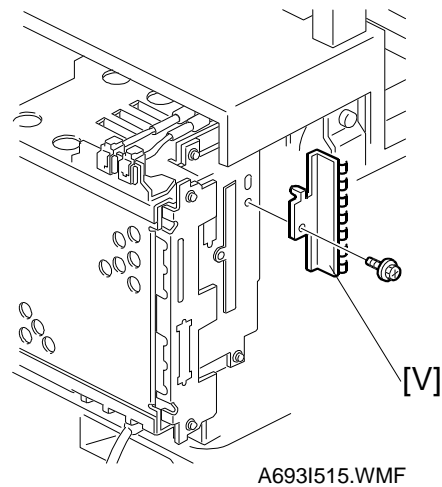
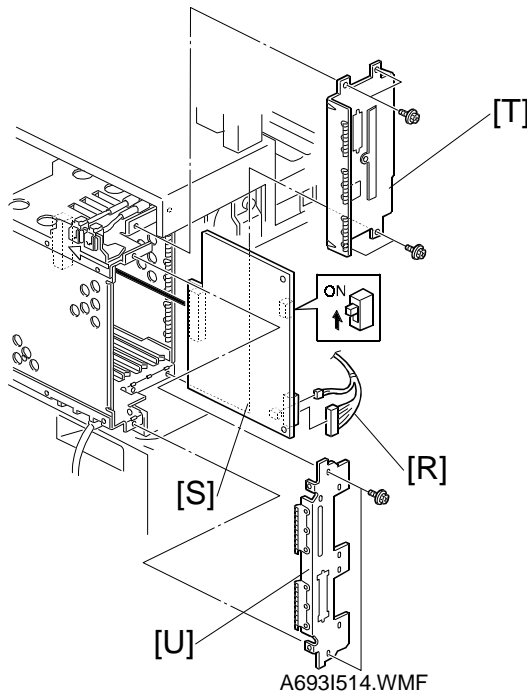
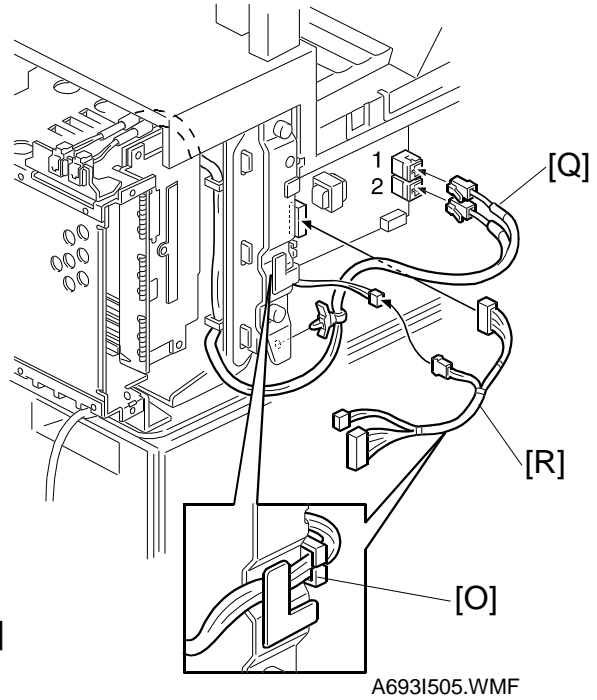
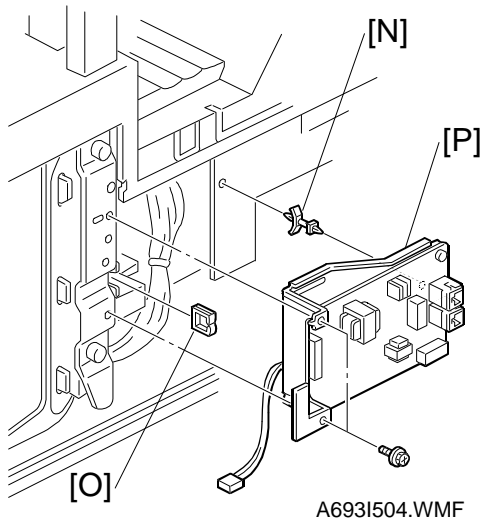

7. Set the locking support [N] and the edge saddle [O] as shown, then install the NCU/Speaker assembly [P] (2 screws).
8. Connect the cable [Q] and the harness [R] as shown. The harness [R] must run through the edge saddle [O] as shown.
9. Turn on the battery switch (SW1) on the FCU [S] then set it in the right-most slot of the expansion box as shown. Connect the harness [R] to the FCU (CN328 and CN330), then slide the FCU [S] all the way in (1 connector).
10. Install the brackets [T] (3 screws), [U] (2 screws) and [V] (1 screw) as shown.  
**NOTE:** The bracket [U] is installed only in the model for Taiwan.

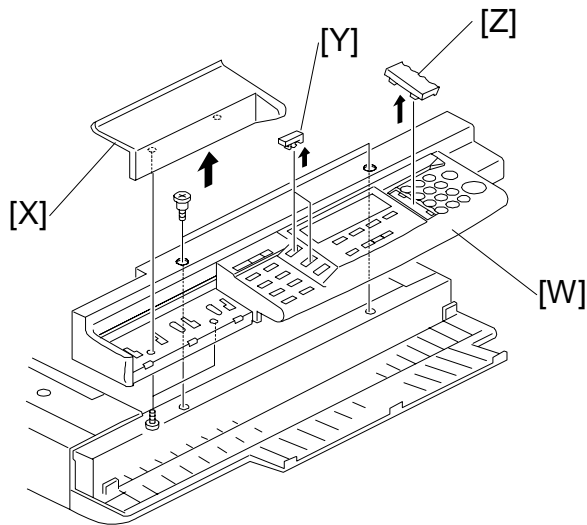

A6931507.WMF

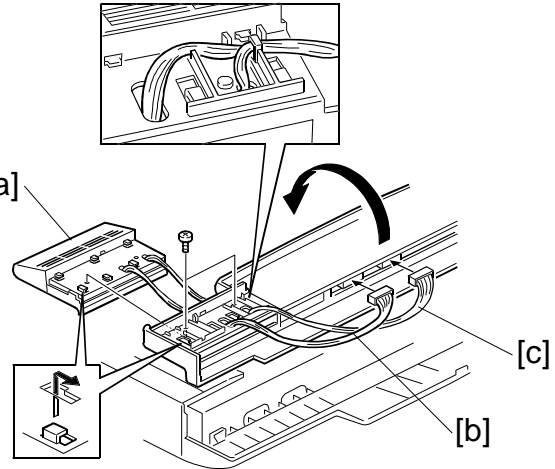

A6931508.WMF

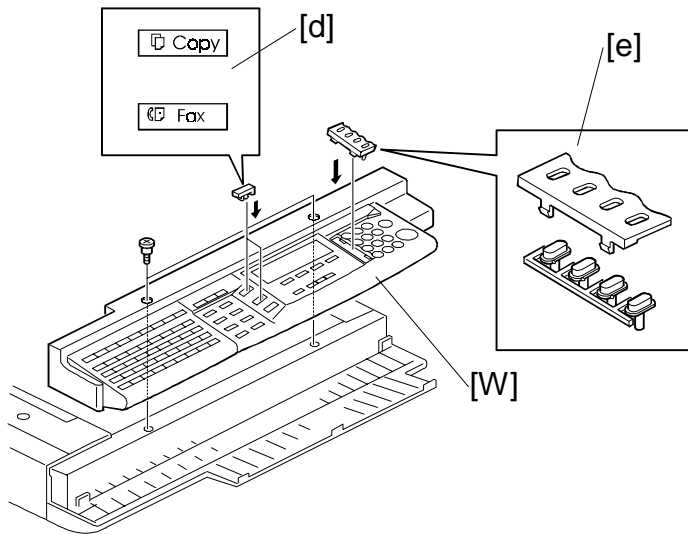

A6931509.WMF

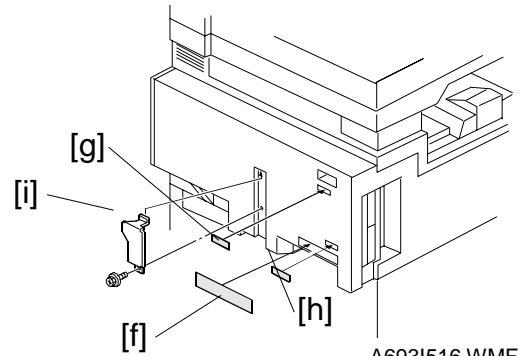

A6931516.WMF

11. Remove the operation panel [W], then remove parts [X], [Y], and [Z].
12. Install part [a], then connect the harnesses [b] and [c] to the operation panel as shown.
13. Replace the operation panel [W], then install the parts [d] and [e], as shown.
14. Replace the left side cover (4 screws) and the rear cover (4 screws).
15. Affix the serial number label [f], the LINE/TEL label [g] and the appropriate approval label [h] onto the rear cover. Then install the bracket [i] (1 screw).
16. Attach the "Super G3" label [j] to the front cover.

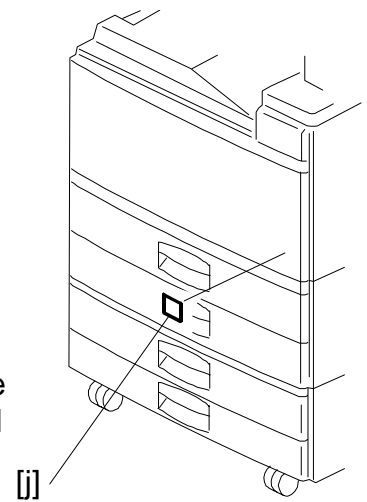

A6931511.WMF

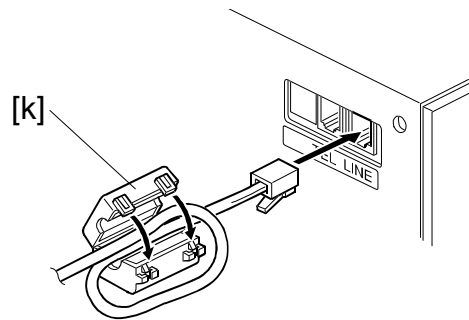

A693I517.WMF

17. Wrap the phone line around the core [k] as shown, and connect it to the “LINE” jack at the rear of the machine.
18. Plug in the machine and turn on the main power switch.
19. Press the ‘Facsimile’ key and check the facsimile LED lights.  
At this time, the display reads: SC1201 - Functional problem with the fax. Data should be initialized.  
**NOTE:** This is not a functional problem. The machine shows this message only when the fax unit is first installed. If the same message appears at the next power-on, check whether the battery switch (SW1) on the FCU has been turned on.
20. Press “Yes” to initialize the fax unit.
21. Set up and program the items required for fax communications as shown below. If the user function keys (F1, F2, F3, F4, and F5) need to be programmed, attach the label.

The default settings of the user function keys are as follows:

- F1: Start Manual Rx
- F2: Tx Result Display
- F3: TEL Mode
- F4: Not programmed
- F5: Not programmed

**NOTE:** Be sure to set the clock (date and time).

Program the serial number into the fax unit (service function 10). The serial number can be found on the serial number label (attached to the machine in step 15).

---

## Chapter 4

### 4.5 Service RAM Addresses

Two addresses are mentioned for the Rx counter, 4801C4 - 4801C6 (H) and 480A64 - 480A67 (H). This is not correct. 480A64 - 480A67 (H) is the correct address range.

---

## Chapter 5

### Section 5.4.1 (Page 5-7)

#### *Problem*

**SW3 on the FCU MUST BE TURNED OFF** after downloading firmware from a flash memory card, but the manual does not explain this.

If SW3 is kept on at power-up, the fax application will not start without a 'master' flash memory card connected.

#### *Correction*

Insert the underlined step after step 8 on page 5-7 as shown below.

8. Turn off the main power switch then disconnect the flash memory card.

**9. Turn OFF (lower position) SW3 below the card slot.**

10. Turn the machine back on.

RC	RE	ASIA	

Model: NAD 30S/30/40 FAX Option Type 450		Date: 20-Jan-99	No.: 01
Subject: Software Release Information		Prepared by: E.Fukuyama	
From: GTSS Field Information Depot			
Classification:	<input type="checkbox"/> Troubleshooting	<input type="checkbox"/> Part information	<input type="checkbox"/> Action required
	<input type="checkbox"/> Mechanical	<input type="checkbox"/> Electrical	<input type="checkbox"/> Service manual revision
	<input type="checkbox"/> Paper path	<input type="checkbox"/> Transmit/receive	<input type="checkbox"/> Retrofit information
	<input checked="" type="checkbox"/> Other ( )		

The new version 7.02 of the FCU firmware has been implemented in the production machines.

### Corrections

No,	Title	Details of Errors
1	CNG Signal Interval	Auto Reception sometimes does not work with the 3 second CNG Signal Interval. Use G3 switch 0E to change this setting as shown below. G3SW 0E 3.0s 2.9s 2.8s 2.7s Bit 0 : 0 1 0 1 Bit 1 : 0 0 1 1
2.	Memory Report	When a message is stored for polling transmission, the memory report prints out even though the auto print out function is off.
3	Transmission Error in V34	A transmission error may occur when using some kinds of PBX, if the V8 function is used on an extension line. The communication switches 1E and 1F are newly added to disable the V8 function when the switch setting coincides with the first digit of the extension number. For example, to disable V8 for an extension starting with 9, turn on SW 1F bit 1. SW 1E b0 b1 b2 b3 b4 b5 b6 b7 #0 #1 #2 #3 #4 #5 #6 #7 SW 1F #8 #9
4	Original Scan Problem	The fax function is reset when a print paper mis-feed occurs during an original scan.
5	PTT for Denmark/Netherlands/Switzerland	There are no parameters for obtaining PTT approval in Denmark, Netherlands, and Switzerland.
6	Flash ROM Algorithm	The flash ROM is discontinued and the algorithm should be changed to a new one. The old ROM can also be used.

This fixes the bug created with version 5.04.

Model: NAD 30S/30/40 FAX Option Type 450	Date: 20-Jan-99	No.: 01
--	-----------------	---------

**Production Cut-in Number**

A693-17 : A7848110018

A693-19 : From January production

A693-27 : A7848110164

A693-29 : A7848120401

A693-67 : From January production

A693-68 : From January production



Model: NAD 30S/30/40 (Fax Option)		Date: 15-Mar-00	No.: RA230054
Subject: Software Release Information		Prepared by: E. Fukuyama	
From: Technical Services Dept., GTS Division			
Classification:	<input type="checkbox"/> Troubleshooting	<input type="checkbox"/> Part information	<input type="checkbox"/> Action required
	<input type="checkbox"/> Mechanical	<input type="checkbox"/> Electrical	<input type="checkbox"/> Service manual revision
	<input type="checkbox"/> Paper path	<input type="checkbox"/> Transmit/receive	<input type="checkbox"/> Retrofit information
	<input checked="" type="checkbox"/> Other (        )		

The following is the modification history for firmware versions 10.00, 11.00 and 12.00.

Software Version: 12.00

Program Number:        A2335581G (NA)                    A2335592F (EU4)  
                               A2335597F (China)                A2335593F (EU5)  
                               A2335584F (Taiwan)                A2335594F (EU6)  
                               A2335582J (EU1)                    A2335595F (EU7)  
                               A2335590F (EU2)                    A2335596F (EU8)  
                               A2335591F (EU3)

- Corrections Version10.00 -

No,	Title	Details of Errors
1	Cannot print out incoming fax.	Even if only one of the output trays has not been set properly, it is not possible to print out an incoming fax to any tray.
2.	System Switch	The default for System Switch 0A (Germany) has been changed from 00H to 30H.

- Corrections Version11.00 -

1	Print end buzzer	If fax printout and communication finish at the same time when using Direct Receive, the print end buzzer does not turn off.
2	SC101 does not stop transmission	Transmission is not stopped even if SC101 occurs.

- Corrections Version12.00 -

1	Duplex Print	Page order is reversed in duplex mode if the page memory unit has not been installed (2/1, 4/3). The specifications have been changed so that the order will be 1/2, 3/4 (this is correct). As part of this modification, the default for Printer Switch 0F bit 5 has been changed to 1.
2	FCC Standards (86)	The following modification was made to comply with the changes made to FCC standards (86) and applies only to A2335581G: 1. The default for communication switch 10 has been changed to 02H. 2. The default for communication switch 12 has been changed to 0AH.